

# Prizm Vinyl Fence Installation Guide

## TOOLS and MATERIALS Required

- Circular Saw (Only if modifications are required; be sure to use a blade compatible with plastic material.)
- Concrete Mix
- Drill
- Level
- Stakes
- String (Nylon Ball Cord)
- Tamping Bar
- Tape Measure
- Post Hole Digger or Power Auger
- Shovel
- Rubber Mallet

## Types of Posts

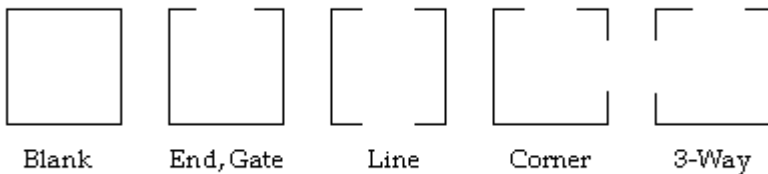

## STEP 1: PRELIMINARY PLANNING

- Verify local building codes for restrictions and requirements regarding the proposed fence project (e.g., setbacks, easements, zoning regulations, height restrictions, etc...).
- Obtain a building permit if required by the township/municipality/borough. Local codes may have height restrictions or require clearances.
- Survey location for property lines (if needed).
- Before excavation can begin, underground utilities must be located.

*Note: If you are unaware of the organization in your area that ensures the location of underground utilities please contact North America One Call Referral Service @ 1-888-258-0808.*

## STEP 2: LAYOUT

- Have a drawing including measurements and gates for the proposed fence project.
- Stake out the fence line from beginning to end, including all corners and gates.
- Tie a string tautly between corner post locations. This will define the line along which the line posts will be placed.

## FENCE STYLES

### **PICKET**

Harrisburg, Sunbury, and York  
Franklin and Hazleton

## ON CENTER MEASUREMENT

72" or 94"  
96"

### **LATTICE**

Pocono

94"

### **PRIVACY**

Kinzer  
Carlisle, Lancaster and Williamsport  
Bedford  
Latrobe

92" or 71.5"  
94" or 72"  
95"  
71"

# Prizm Vinyl Fence Installation Guide

## FENCE STYLES

### CONTEMPORARY

Allentown, Altoona, Breezewood,  
Hershey, Johnstown, Somerset

## ON CENTER MEASUREMENT

72"

### STEP 3: INSTALLATION

1. Find the most appropriate starting position.
2. Fence sections should be set approximately 2" from ground level. Since most ground is not level, the spacing under the fence will vary.
3. All fence posts should be set in concrete: lines, corners, ends and gate posts.
4. Mark the location of the first 1-3 holes.
5. Dig holes to prescribed depth and width (see chart) using either a manual post hole digger or power auger; **dig no more than 1-3 holes at a time.**

Fence Style and Height	Post Size	Depth of Hole	Diameter of Hole
Picket, Lattice (Pocono) and Contemporary styles 36", 42" and 48" High	4" x 4" x 72"	24"	6"-8"
Picket and Contemporary styles 60" and 72" High	4" x 4" x 108"	30"-36"	6"-8"
Privacy styles 48" High	4" x 4" x 72"	24"	6"-8"
Privacy styles 60" and 72" High	4" x 4" x 108"	30"-36"	8"-12"
Picket, Lattice (Pocono) and Contemporary styles 36", 42" and 48" High	5" x 5" x 72"	24"	8"-10"
Picket and Contemporary styles 60" and 72" High	5" x 5" x 108"	30"-36"	8"-10"
Privacy styles 48" High	5" x 5" x 72"	24"	8"-10"
Privacy styles 60" and 72" High	5" x 5" x 108"	30"-36"	8"-12"

6. Pour 2" of concrete in the bottom of the hole. We recommend using a dry, quick setting concrete mix.
7. Plumb and level post in the existing hole before adding additional concrete.
8. Add concrete around post; about 2" on all sides.
9. Tamp concrete until 3"-6" remains before ground level (see Figure 1).

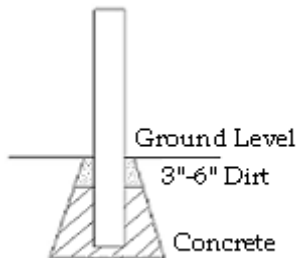
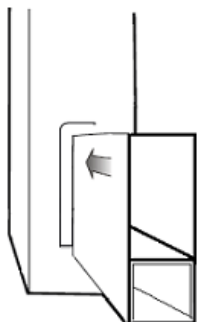

Figure 1

10. If the ground is extremely dry, add water to make concrete damp. Otherwise, the dry concrete mixture will draw moisture from the ground and harden the concrete.
11. Backfill dirt on top of concrete; tamp.

# Prizm Vinyl Fence Installation Guide

12. Attach section to post; insert notched rail into routed holes on post until tabs click inside the post, put tabs tight against the inside wall of the post (see Figure 2).



**Figure 2**

13. If a section needs modified from its original size there is a possibility the notch will be cut off. If this occurs you can pin the top rail inside the post by placing a stainless steel screw in the horizontal rail from inside the upright post (see Figure 3).

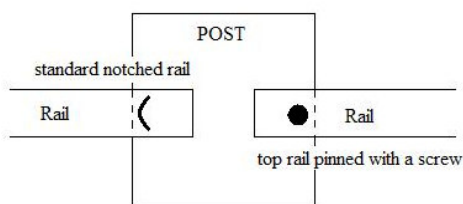
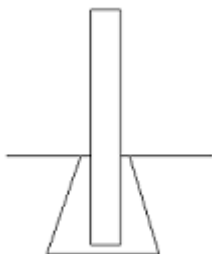

**Figure 3**

14. Set next post

Note:

- These dimensions are for guideline purposes only. These instructions are not all inclusive and do not intend to preclude any other method that is proven equal to or given better performance under extreme weather conditions.
- Post holes should be set below the frost line.
- The bottom of the hole should be larger in diameter than the top (see Figure 4).



**Figure 4**

# Prizm Vinyl Fence Installation Guide

## Post Reinforcement

- All gate posts (hinge and latch side) need to be reinforced.
  - Aluminum stiffener (purchased from Prizm Vinyl)
  - Pressure treated lumber
  - Concrete and rebar
- In the event that your fence line is particularly long, a reinforcement every fifth post will also add extra stability.

## **GATE INSTALLATION**

1. Use end posts for hinge and latch posts.
2. Gates will **NOT** follow the grade of the land and should be placed at a level area.
  - a. Single Gates
    - i. Gates must be square in order to swing properly. Installing a gate on the slightest of slopes will create gaps (sometimes significant) under the fence. Also, it is sometimes impossible to line up the horizontal rails of the gate with the horizontal rails of the fence.
  - b. Double Drive Gates
    - i. A drop rod assembly and latch will be used to hold the two gates closed.
    - ii. Depending on the width a caster may be used to support the gates in the center.
    - iii. On sloped areas, the gaps under the gate will be even greater due to the distance covered.
3. Set the gate opening 2-3" wider than the actual gate size to allow clearance for the hardware; Ex. 36" wide gate requires a 38"-39" opening. Clearance between the gate uprights and gate posts is necessary for full range of motion.
4. Posts need extra strength to support the gate. Determine your method of reinforcement for the gate posts; Prizm Vinyl recommends aluminum Gate Post Stiffeners for posts on both sides (latch and hinge side) of the gate. Set gate posts and reinforcements in concrete making sure they are plumb, level & aligned; allow concrete to set 24 hours prior to attaching gate.
5. Attach the hinge assembly (**follow manufacturer's instructions; included in hardware package**)
  - The placement of the hinge determines the direction the gate will swing.
  - The hinges may have to be adjusted in the future due to the ground settling around the gate posts.
6. Attach the latch assembly (**follow manufacturer's instructions; included in hardware package**)
  - Consider any local code restrictions, latch height and child safety.
7. Place caps on gate uprights.

## Final Steps

- Place post caps on posts; can be glued using PVC adhesive.
- Allow concrete to cure 48 hours prior to pushing against any posts.
- Clean up any extra dirt, tools, etc.